



Conforms to the CE marking

GC67 Digital Pressure Gauge

OUTLINE

The GC67 is a digital pressure gauge with comparator output for FA facilities capable of handling a wide range of liquids.

FEATURES

- The integrated welded construction of the pressure resistant, corrosion resistant, and durable stainless steel diaphragm sensor and socket improves reliability.
- Compact size with a large (character height 10mm) LED display.
- Improved pressure switch response and two high-speed comparator outputs.
- Optional analog output for monitor.

BASIC FUNCTIONS

- **Display scaling allows display and setting of conversion value, etc.**
Scaling range: -1.9.9.9 ~ +1.9.9.9
- **Quick response [2.5ms] comparator output**
NPN open collector X 2 outputs (30V DC, 80mA max.)
- **Filter function suppresses pressure pulsations**
Settable in five steps of 2.5ms (without filter), 10ms, 50ms, 200ms, and 600ms.
- **Comparator operation can be selected from either hysteresis or window.**
Dead band Hysteresis mode: Variable
Window mode: 1%F.S. fixed
- **Hold functions**
Peak hold and bottom hold functions constantly memorize the maximum and minimum pressures.
- **One-touch zero adjustment function**

SPECIFICATION

Pressure range (Max. display digits):

-100~100kPa (100)
0~1MPa (1,000)
-0.1~1MPa (1,000)

Applicable fluid:

Air, water, oil (gases and liquid do not corrode the connection)

Wetted parts materials:

SUS630 (17-4PH), SUS304

Case material:

Front case: PC/ABS
Rear case: ADC12

Max. allowable pressure:

Twice the pressure range.

Accuracy:

Display accuracy: $\pm(1.0\%F.S. + 1 \text{ digit})$
Temperature coefficient: $\pm 0.1\%F.S./^{\circ}C$ (Zero point and span)

Display:

Display type: 3-1/2-digit LED display (character height 10mm)
Display period: 0.2s

Power source/current consumption:

12~24V DC $\pm 10\%$ /30mA DC or less

Comparator output:

Open collector NPN type 2 outputs (30V DC, 80mA max.)
Hysteresis, window comparator modes
Response time: 2.5ms (without filter)
Protection circuit: Short circuit (overcurrent) protection

Analog output (Option):

Voltage output: 1~5V DC Load resistance 10k Ω or over
Output accuracy: $\pm 3\%F.S.$
Response time: 1ms or less

Cable:

Length: 2m

Operating temperature range:

-10~50 $^{\circ}C$

Operating humidity range:

35~85%RH (There shall be no condensation.)

Protection class:

Indoor specifications (IP40)

Pressure connection port dia.:

R1/8, M5

Weight:

Approx. 95g (including 2m cable)

DIMENSIONS

Horizontal mounting

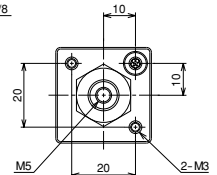
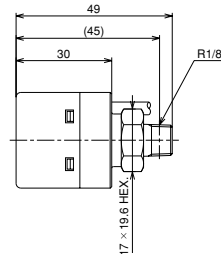
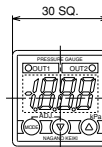
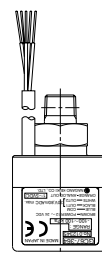

Wiring

Brown	Power source (+)
Blue	Power source (-)
Black	Open collector output (OUT1)
White	Open collector output (OUT2)
Orange	Analog output (Option)

Vertical mounting

